

# H.265+ AF Motorized Mini Dome Network Camera



IP67

IK10

DATASHEET

## KEY FEATURES

- ▶ **Smart Stream** (Bandwidth, storage and bit rate are saved with Smart Stream ON, eg, H.265+ saves 70%~80% bandwidth that of H.264.)
- ▶ **Smart IR II** (Combining the High Beam and Low Beam to adjust IR intensity to fit different lighting conditions.)
- ▶ **Video Content Analysis** (With 10 detection modes, VCA greatly enhances the performance bringing comprehensive surveillance functions.)
- ▶ **Advanced Functions** (Boasting to support various advanced functions such as HLC, Defog, ROI.)
- ▶ **Multi-Interface** (Easy installation with built-in Microphone, PoE and DC12V.)
- ▶ **SIP** (Session Initiation Protocol. Providing audio/alarm/intercom and video streaming for mobile phones and video phones.)
- ▶ **3-Axis Mechanical Design** (Featuring 3-axis mechanical design for fast and easy adjustment of the camera's viewing angle.)

### 140dB Super WDR

Milesight's sensor-based WDR technology allows the camera to record greater scene details with true color reproduction even under the extreme back light and high contrast conditions. The ratio that the brightest light signal values divided by the darkest light signal values is up to 140dB.



### 0.002Lux Ultra Low-light

The starlight camera is able to deliver high detailed color images even in low light environment reaching 0.002Lux(Color) or 0Lux(B/W), and near infrared light environments without any supplementary lighting.

### 3x Optical Zoom

The 3x optical zoom(2.8~8.4mm@F1.8~F2.7) can zoom up to distant subjects while still maintaining the clarity, delivering high quality video over the entire zoom range.

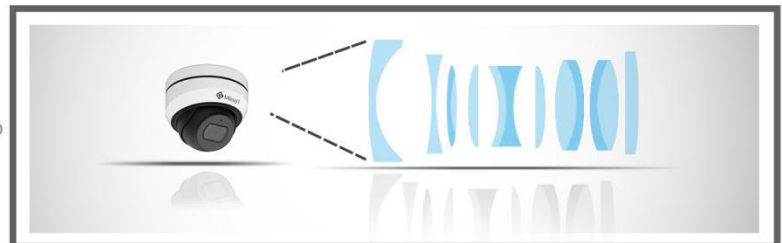

### IP67&IK10

Supporting IP67-rated weather proofing and IK10-rated vandal proof which are the leading level of the industry, the camera is well protected against adverse impact to ensure the performance.

# H.265<sup>+</sup> AF Motorized Mini Dome Network Camera



|         | Model                     | MS-C2975-EPB<br>(2MP)   | MS-C5375-EPB<br>(5MP)  |
|---------|---------------------------|---|--|
| Camera  | Image Sensor              | 1/2.8" Progressive Scan CMOS  |  |
|         | Min. Illumination         | Color: 0.002Lux@F1.2<br>B/W: 0Lux with IR on  | Color: 0.005Lux@F1.2<br>B/W: 0Lux with IR on                                 |
|         | WDR                       | 140dB Super WDR   | 120dB Super WDR  |
|         | Shutter Time              | 1/100000s~1s  |  |
|         | IR Distance               | Up to 35m   |  |
|         | Day&Night                 | ICR Filter Auto Switch  |  |
|         | S/N                       | >55dB   |  |
| Lens    | Lens                      | 2.8~8.4mm, 3X Optical Zoom  |  |
|         | Field of View             | H111°~H48°/D130°~D55°/V60°~V27°   | H101°~H42°/D129°~D53°/V74°~V31°  |
|         | Focus Control             | Auto/Manual   |  |
|         | Minimum Working Distance  | 200~500mm (Wide-Tele)   |  |
|         | Aperture                  | F1.8~F2.7   |  |
|         | Iris Control              | Auto  |  |
| Video   | Max. Image Resolution     | 1920x1080   | 2592x1944  |
|         | Primary Stream            | 30fps@(1920x1080, 1280x960, 1280x720, 704x576)  | 20fps@(2592x1944), 30fps@(2048x1536, 1920x1080, 1280x960, 1280x720, 704x576) |
|         | Secondary Stream          | 30fps@(704x576, 640x480, 640x360, 352x288, 320x240, 320x192, 320x180)   |  |
|         | Tertiary Stream           | 30fps@(1920x1080, 1280x720, 704x576, 640x480, 640x360, 320x240, 320x192, 320x180)   |  |
|         | Video Compression         | H.265 <sup>+</sup> /H.265(HEVC)/H.264 <sup>+</sup> /H.264/MJPEG   |  |
|         | Video Bit Rate            | 16Kbps~16Mbps(CBR/VBR Adjustable)   |  |
|         | Image Setting             | Brightness/Contrast/Saturation/Sharpness  |  |
| Network | Ethernet                  | 1*RJ45 10M/100M Ethernet Port   |  |
|         | Network Storage           | NAS(Support NFS, SMB/CIFS)  |  |
|         | Protocol                  | IPv4/IPv6, ARP, TCP, UDP, RTP, RTSP, RTCP, HTTP, HTTPS, DNS, DDNS, DHCP, FTP, NTP, SMTP, SNMP, UPnP, Bonjour, SIP, PPPoE, VLAN, 802.1x, QoS, IGMP, ICMP, SSL  |  |
| Audio   | Audio Compression         | G.711/AAC/G.722/G.726   |  |
|         | Audio Interface           | Built-in Microphone   |  |
| System  | Alarm I/O                 | 1/1 (Multi-interface Version)   |  |
|         | Storage                   | Support microSD/SDHC/SDXC Card Local Storage, up to 256G  |  |
|         | Advanced Function         | Privacy Masking, BLC, HLC, 2D DNR, 3D DNR, ROI, Defog, AWB, EIS, IP Address Filtering, AGC, Anti-flicker, Corridor Mode, Deblur   |  |
|         | SIP/VoIP Support          | Yes, Voice & Video-over-IP  |  |
|         | Event Trigger             | Motion Detection, Network Disconnection, Audio Alarm, etc.;   |  |
|         | Event Action              | Motion Detection, Network Disconnection, External Input, Audio Alarm, etc. (Multi-interface Version)<br>FTP Upload, SMTP Upload, SD Card Record, SIP Phone, HTTP Notification, etc.;  |  |
|         | Video Analysis (Optional) | FTP Upload, SMTP Upload, SD Card Record, External Output, SIP Phone, HTTP Notification, etc. (Multi-interface Version)<br>Region Entrance, Region Exiting, Advanced Motion Detection, Tamper Detection, Line Crossing, Loitering, Human Detection, People Counting, Object Left, Object Removed |  |
|         | System Compatibility      | ONVIF Profile S & G & T   |  |
| General | Working Temperature       | -40°C~60°C  |  |
|         | Working Humidity          | 0~90%(Non-condensing)   |  |
|         | Power Supply              | PoE (802.3af)/ DC 12V±10%   |  |
|         | Power Consumption         | 3.6W MAX<br>6W MAX (With IR on)   |  |
|         | Weather Proof             | Up to IP67-rated for Weather-resistant Performance  |  |
|         | Housing                   | Vandal-proof IK10-rated Metal Housing   |  |
|         | Weight                    | 620g  |  |
|         | Dimensions                | Φ108mmX96.5mm   |  |
|         | Warranty                  | 3/5 Years   |  |

# H.265+ AF Motorized Mini Dome Network Camera



## Structure Diagrams

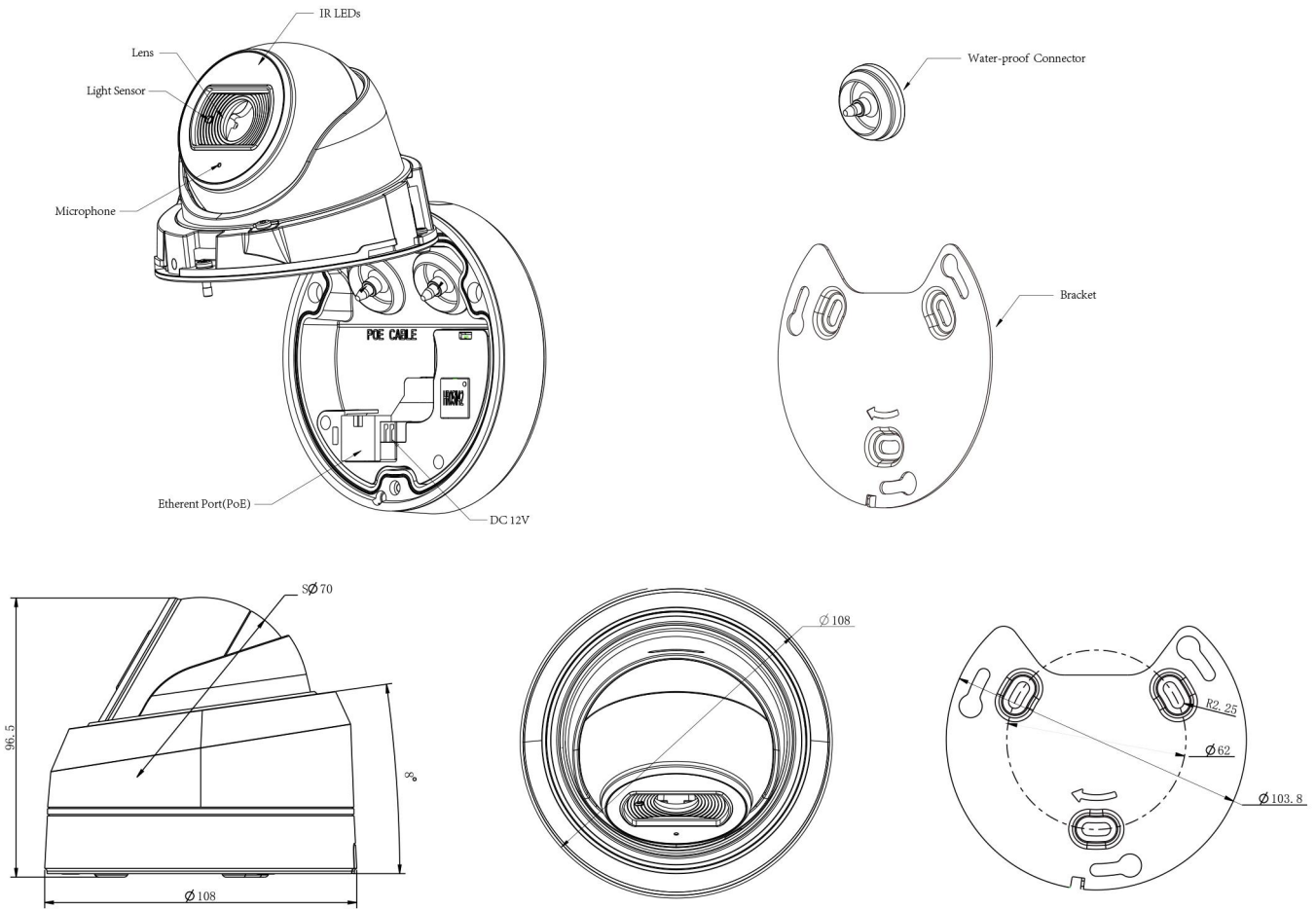

Units: mm

## Accessories Support

A01 Pole Mount

Weight: 720g  
Dimensions: 170\*51.5\*152.6mm



A02 Internal Corner Bracket

Weight: 540g  
Dimensions: 170\*23.2\*205.3mm



A03 External Corner Bracket

Weight: 900g  
Dimensions: 170\*152.6\*76.3mm



A71 Wall Mount

Weight: 530g  
Dimensions: 162\*124\*78 mm



Milesight Technology Co.,Ltd. | [www.milesight.com](http://www.milesight.com)

Contact Us : [sales@milesight.com](mailto:sales@milesight.com) [support@milesight.com](mailto:support@milesight.com)

Add : 220 NE 51st Street, Oakland Park, Florida 33334, USA  
Tel : +1-800-561-0485

Add : 925, Anyang SK V1 Center, LS -ro 116beon-gil, Dongan-gu, Anyang-si, Korea  
Tel : +82-31-990-7772

Add : No.23 Wanghai Road, 2nd Software Park, Xiamen, China  
Tel : +86-592-5922772

